

# Threaded Flanges

## 150#

Nominal Pipe Size	Outside Diam. D	Diam. of Bore	Thickness Min. B	Length thru Hub H	Diam. at Base of Hub M	O.D. of Raised Face G	Minimum Thread Length (T)	Number of Holes	Diam of Holes I	Bolt Circle Diam. K	Approx Weight Kg
1/2"	90	-	11.6	16	30.2	35.1	16	4	15.7	60.5	0.4
3/4"	100	-	13.2	16	38.1	42.9	16	4	15.7	69.9	0.6
1"	110	-	14.7	18	49.3	50.8	17	4	15.7	79.2	0.8
1.1/4"	115	-	16.3	21	58.7	63.5	21	4	15.7	88.9	1.1
1.1/2"	125	-	17.9	23	65	73.2	22	4	15.7	98.6	1.4
2"	150	-	19.5	26	77.7	91.9	25	4	19.1	120.7	2.1
2.1/2"	180	-	22.7	29	90.4	104.6	29	4	19.1	139.7	3.3
3"	190	-	24.3	31	108	127	30	4	19.1	152.4	3.9
3.1/2"	215	-	24.3	32	122.2	139.7	32	8	19.1	177.8	4.8
4"	230	-	24.3	34	134.9	157.2	33	8	19.1	190.5	5.3
5"	255	-	24.3	37	163.6	185.7	36	8	22.4	215.9	6.1
6"	280	-	25.9	39	192	215.9	40	8	22.4	241.3	7.6
8"	345	-	29	45	246.1	269.7	44	8	22.4	298.5	12.1
10"	405	-	30.6	50	304.8	323.9	49	12	25.4	362	16.5
12"	485	-	32.2	56	365.3	381	56	12	25.4	431.8	27
14"	535	-	34.4	58	400.1	412.8	57	12	28.4	476.3	35
16"	595	-	37	64	457.2	469.9	64	16	28.4	539.8	45
18"	635	-	38.1	69	505	533.4	68	16	31.8	577.9	49
20"	700	-	43.3	73	558.8	584.2	73	20	31.8	635	62
24"	815	-	48.1	83	663.4	692.1	83	20	35.1	749.3	87

Note: raised face are included in flange thickness

All dimensions are in mm

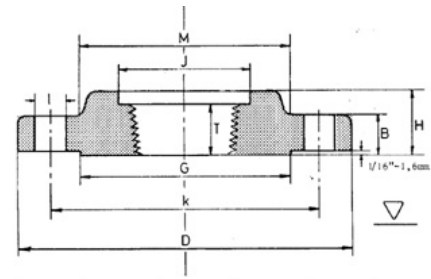

## 300#

Nominal Pipe Size	Outside Diam. D	Diam. of Bore	Thickness Min. B	Length thru Hub H	Diam. at Base of Hub M	O.D. of Raised Face G	Minimum Thread Length (T)	Number of Holes	Diam of Holes I	Bolt Circle Diam. K	Approx Weight Kg
1/2"	95	23.6	14.7	23	38	35	16	4	15.7	66.5	0.7
3/4"	115	29	16.3	26	48	42.9	16	4	19	82.5	1.2
1"	125	35.8	17.9	27	54	50.8	18	4	19	88.9	1.4
1.1/4"	135	44.4	19.5	27	64	63.5	21	4	19	98.5	1.7
1.1/2"	155	50.5	21.1	31	70	73.1	23	4	22.3	114.3	2.5
2"	165	63.5	22.7	33	84	91.9	29	8	19	127	2.9
2.1/2"	190	76.2	25.9	39	100	104.6	32	8	22.3	149.3	4.4
3"	210	92.2	29	43	117	127	32	8	22.3	168.1	5.9
3.1/2"	230	104.9	30.6	45	133	139.7	37	8	22.3	184.1	7.4
4"	255	117.6	32.2	48	146	157.2	37	8	22.3	200.1	10
5"	280	144.5	35.4	51	178	185.6	43	8	22.3	234.9	12.3
6"	320	171.4	37	53	206	215.9	47	12	22.3	269.7	15.6
8"	380	222.2	41.7	62	260	269.7	51	12	25.4	330.2	24.2
10"	445	276.3	48.1	67	321	323.8	56	16	28.4	387.3	34.1
12"	520	328.7	51.3	73	375	381	61	16	31.7	450.8	50
14"	585	360.4	54.4	77	425	412.7	64	20	31.7	514.3	70
16"	650	411.2	57.6	83	483	469.9	69	20	35	571.5	89
18"	710	462	60.8	89	533	533.4	70	24	35	628.6	109
20"	775	512.8	64	96	587	584.2	74	24	35	685.8	134
24"	915	614.4	70.3	107	702	692.1	83	24	41.1	812.8	201

Note: raised face are included in flange thickness

All dimensions are in mm

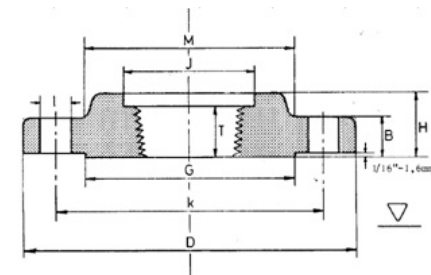

**600#**

Nominal Pipe Size	Outside Diam. D	Diam. of Bore	Thickness Min. B	RF Height	Length thru Hub H	Diam. at Base of Hub M	O.D. of Raised Face G	Minimum Thread Length (T)	Number of Holes	Diam of Holes I	Bolt Circle Diam. K	Approx Weight Kg
1/2"	95	23.6	14.3	7	22	38	35.1	16	4	15.7	66.5	0.8
3/4"	115	29	15.9	7	25	48	42.9	16	4	19.1	82.6	1.3
1"	125	35.8	17.5	7	27	54	50.8	18	4	19.1	88.9	1.6
1.1/4"	135	44.5	20.7	7	29	64	63.5	21	4	19.1	98.6	2.1
1.1/2"	155	50.5	22.3	7	32	70	73.1	23	4	22.4	114.3	3
2"	165	63.5	25.4	7	37	84	91.9	29	8	19.1	127	3.7
2.1/2"	190	76.2	28.6	7	41	100	104.6	32	8	22.4	149.4	5.3
3"	210	92.2	31.8	7	46	117	127	35	8	22.4	168.1	7
3.1/2"	230	104.9	35	7	49	133	139.7	40	8	25.4	184.2	8.9
4"	275	117.6	38.1	7	54	152	157.2	42	8	25.4	215.9	15
5"	330	144.5	44.5	7	60	189	185.7	48	8	28.4	266.7	25
6"	355	171.5	47.7	7	67	222	215.9	51	12	28.4	292.1	29
8"	420	222.3	55.6	7	76	273	269.7	58	12	31.8	349.3	44
10"	510	276.4	63.5	7	86	343	323.9	66	16	35.1	431.8	71
12"	560	328.7	66.7	7	92	400	381	70	20	35.1	489	85
14"	605	360.4	69.9	7	94	432	412.8	74	20	38.1	527.1	99
16"	685	411.2	76.2	7	106	495	469.9	78	20	41.1	603.3	142
18"	745	462	82.6	7	117	546	533.4	80	20	44.5	654.1	173
20"	815	512.8	88.9	7	127	610	584.2	83	24	44.5	723.9	220
24"	940	614.4	101.6	7	140	718	692.1	93	24	50.8	838.2	312

All dimensions are in mm

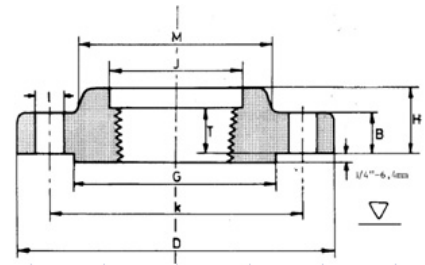

**900#**

Nominal Pipe Size	Outside Diam. D	Diam. of Bore	Thickness Min. B	RF Height	Length thru Hub H	Diam. at Base of Hub M	O.D. of Raised Face G	Minimum Thread Length (T)	Number of Holes	Diam of Holes I	Bolt Circle Diam. K	Approx Weight Kg
1/2"	120	23.6	22.3	7	32	38	34.9	23	4	22.3	82.5	1.8
3/4"	130	29	25.4	7	35	44	42.9	26	4	22.3	88.9	2.3
1"	150	35.8	28.6	7	41	52	50.8	29	4	25.4	101.6	3.6
1.1/4"	160	44.4	28.6	7	41	64	63.5	31	4	25.4	111.2	4.1
1.1/2"	180	50.6	31.8	7	44	70	73.1	32	4	28.4	123.9	5.4
2"	215	63.5	38.1	7	57	105	91.9	39	8	25.4	165.1	10
2.1/2"	245	76.2	41.3	7	64	124	104.6	48	8	28.4	190.5	14
3"	240	92.2	38.1	7	54	127	127	42	8	25.4	190.5	12
4"	290	117.6	44.5	7	70	159	157.2	48	8	31.7	234.9	20
5"	350	144.4	50.8	7	79	190	185.6	54	8	35	279.4	32
6"	380	171.4	55.6	7	86	235	215.9	58	12	31.7	317.5	42
8"	470	222.2	63.5	7	102	298	269.7	64	12	38.1	393.7	71
10"	545	276.2	69.9	7	108	368	323.8	72	16	38.1	469.9	101
12"	610	328.6	79.4	7	117	419	381	77	20	38.1	533.4	133
14"	640	360.4	85.8	7	130	451	412.7	83	20	41.3	558.8	153
16"	705	411.2	88.9	7	133	508	469.9	86	20	44.4	618.9	185
18"	785	462	101.6	7	152	565	533.4	89	20	50.8	685.8	258
20"	855	512.8	108	7	159	622	584.2	93	20	54	749.3	317
24"	1040	614.4	139.7	7	203	749	692.1	102	20	66.5	901.7	606

All dimensions are in mm

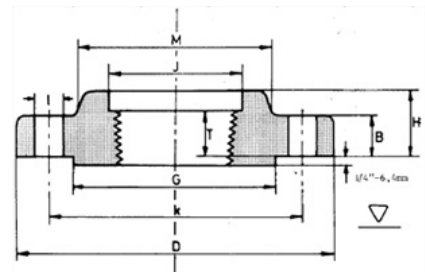

**1500#**

Nominal Pipe Size	Outside Diam. D	Diam. of Bore	Thickness Min. B	RF Height	Length thru Hub H	Diam. at Base of Hub M	O.D. of Raised Face G	Minimum Thread Length (T)	Number of Holes	Diam of Holes I	Bolt Circle Diam. K	Approx Weight Kg
1/2"	120	23.6	22.3	7	32	38	35	26	4	22.3	82.5	1.8
3/4"	130	29	25.4	7	35	44	42.9	26	4	22.3	88.9	2.3
1"	150	35.8	28.6	7	41	52	50.8	29	4	25.4	101.6	3.6
1.1/4"	160	44.4	28.6	7	41	64	63.5	31	4	25.4	111.2	4
1.1/2"	180	50.5	31.8	7	44	70	73.1	32	4	28.4	123.9	5.4
2"	215	63.5	38.1	7	57	105	91.9	39	8	25.4	165.1	10
2.1/2"	245	76.2	41.3	7	64	124	104.6	48	8	28.4	190.5	14
3"	265	92.2	47.7	7	*	133	127	-	8	31.7	203.2	18
4"	310	117.6	54	7	*	162	157.2	-	8	35.1	241.3	40
5"	375	144.5	73.1	7	*	197	185.6	-	8	41.1	292.1	52
6"	395	171.4	82.6	7	*	229	215.9	-	12	38.1	317.5	61
8"	485	222.2	92.1	7	*	292	269.7	-	12	44.4	393.7	103
10"	585	276.3	108	7	*	368	323.8	-	12	50.8	482.6	175
12"	675	328.7	123.9	7	*	451	381	-	16	53.8	571.5	264

All dimensions are in mm

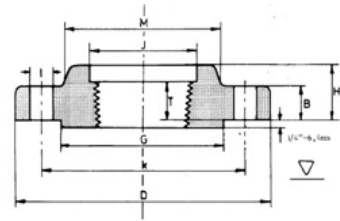

**2500#**

Nominal Pipe Size	Outside Diam. D	Diam. of Bore	Thickness Min. B	RF Height	Length thru Hub H	Diam. at Base of Hub M	O.D. of Raised Face G	Minimum Thread Length (T)	Number of Holes	Diam of Holes I	Bolt Circle Diam. K	Approx Weight Kg
1/2"	135	23.6	30.2	7	40	43	35.1	29	4	22.4	88.9	3
3/4"	140	29	31.8	7	43	51	42.9	32	4	22.4	95.3	3.5
1"	160	35.8	35	7	48	57	50.8	35	4	25.4	108	4.9
1.1/4"	185	44.5	38.1	7	52	73	63.5	39	4	28.4	130	7.2
1.1/2"	205	50.5	44.5	7	60	79	73.2	45	4	31.8	146.1	10
2"	235	63.5	50.9	7	70	95	91.9	51	8	28.4	171.5	15
2.1/2"	265	76.2	57.2	7	79	114	104.6	58	8	31.8	196.9	22
3"	305	-	66.7	7	*	133	127	-	8	35.1	228.6	33
4"	355	-	76.2	7	*	165	157.2	-	8	41.1	273.1	53
5"	420	-	92.1	7	*	203	185.7	-	8	47.8	323.9	84
6"	485	-	108	7	*	235	215.9	-	8	53.8	368.3	128
8"	550	-	127	7	*	305	269.7	-	12	53.8	438.2	188
10"	675	-	165.1	7	*	375	323.9	-	12	66.5	539.8	355
12"	760	-	184.2	7	*	441	381	-	12	73.2	619.3	504

All dimensions are in mm

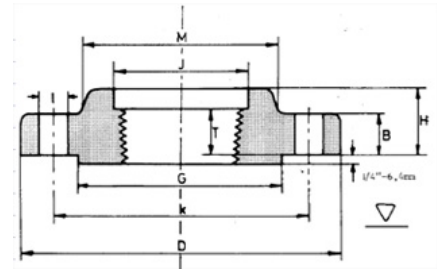

\* There will may be typical error